

室内陈设品手绘技法

主讲：傅嘉芹

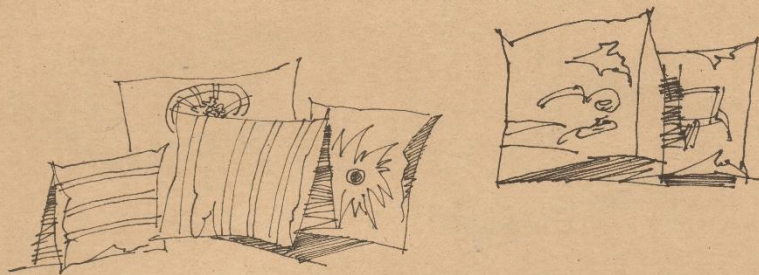

抱枕：注意投影的虚实变化

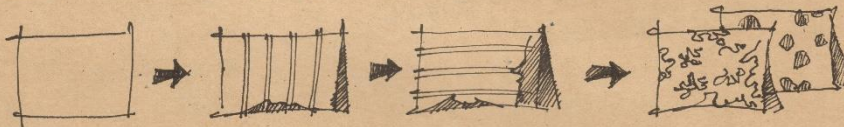

嘉祥控四川新都

2013.5.2

抱枕的纹理可用轻松活泼的线条，更能表现出布艺的质感。

交接处可适当加重，以突出形体。

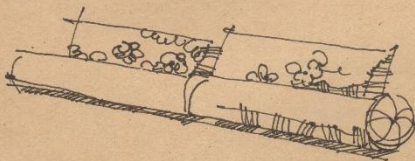
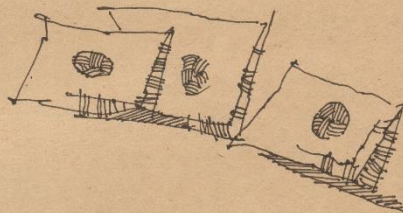
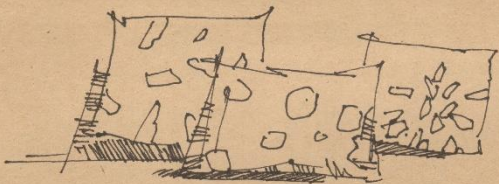
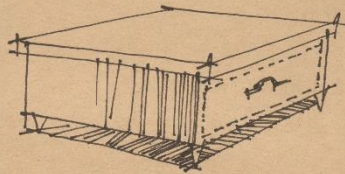
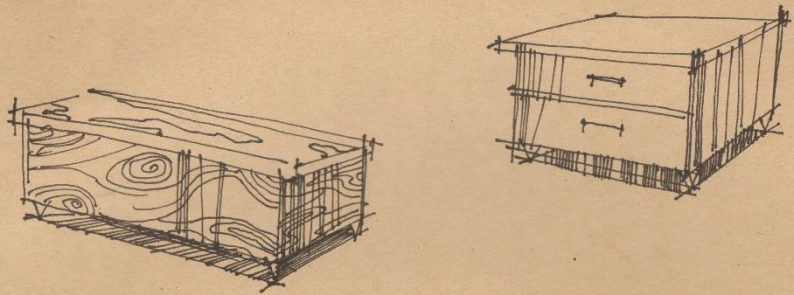

嘉竹 2013.4.18

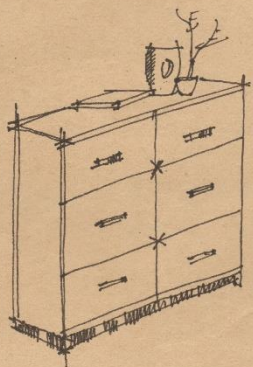

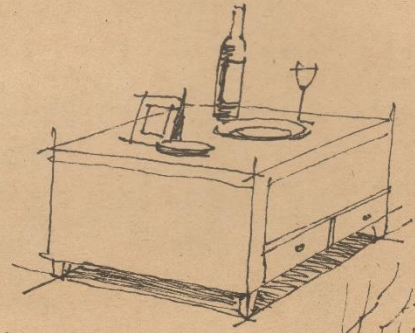
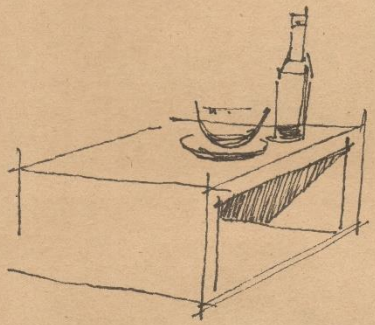
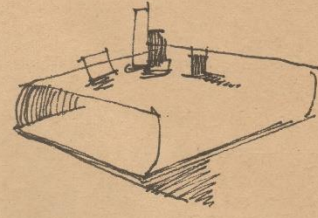
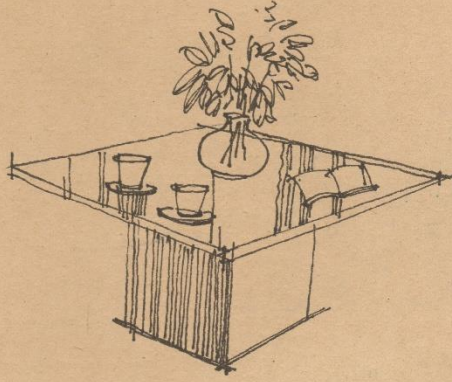

室内茶几
嘉芽於四川成都
2012.3.23

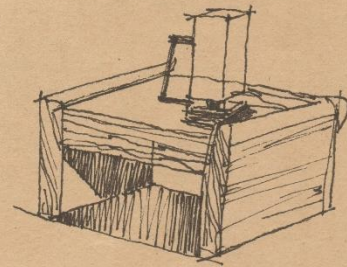
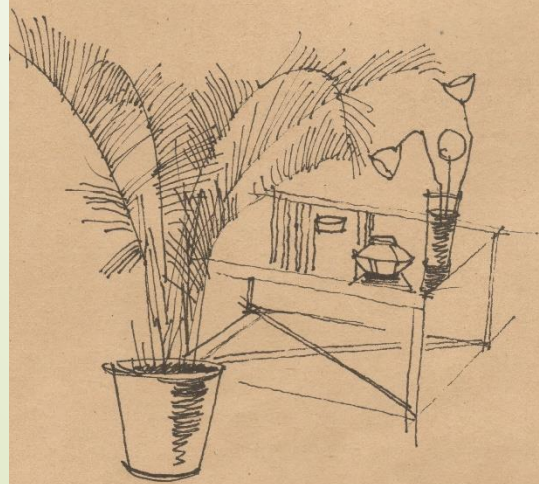

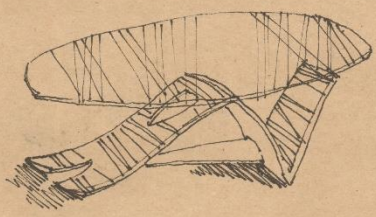
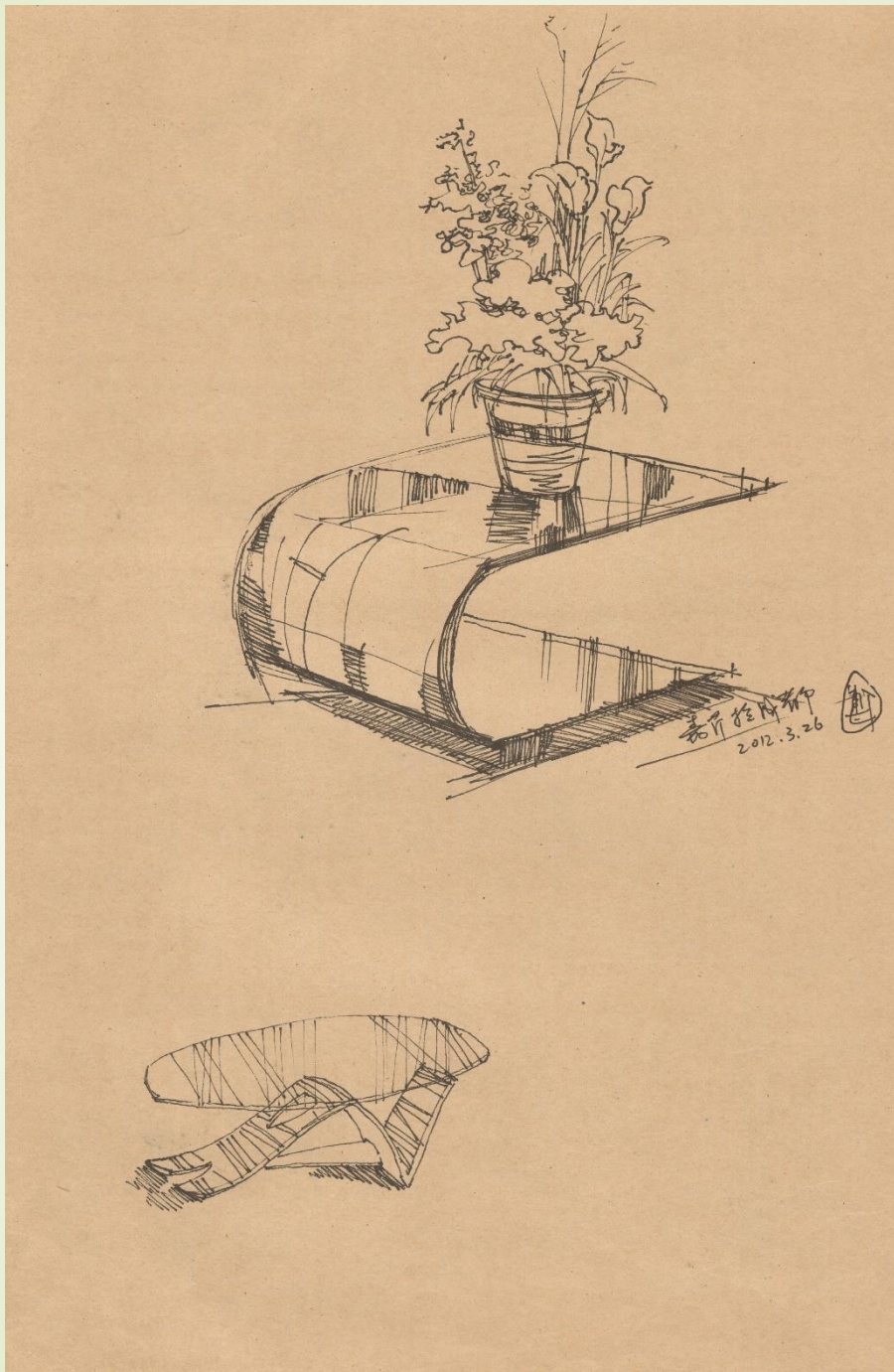
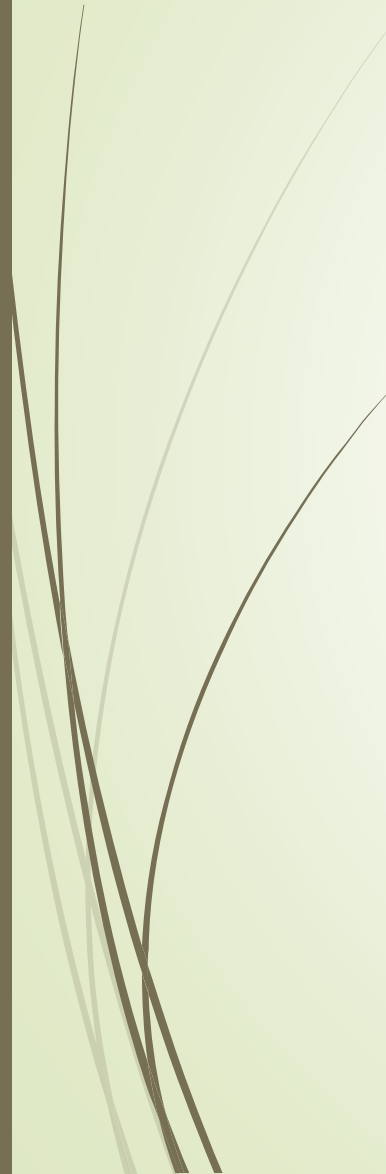



- ▲ 陶器在室内空间中烘托气氛, 丰富画面效果, 不可缺少的艺术品。
陶器造型严谨, 有历史文化的积淀 (沧桑、古朴的美感)
- ▲ 画陶器要概括、夸张、简洁的线条, 生动形象表现, 无须过多细节

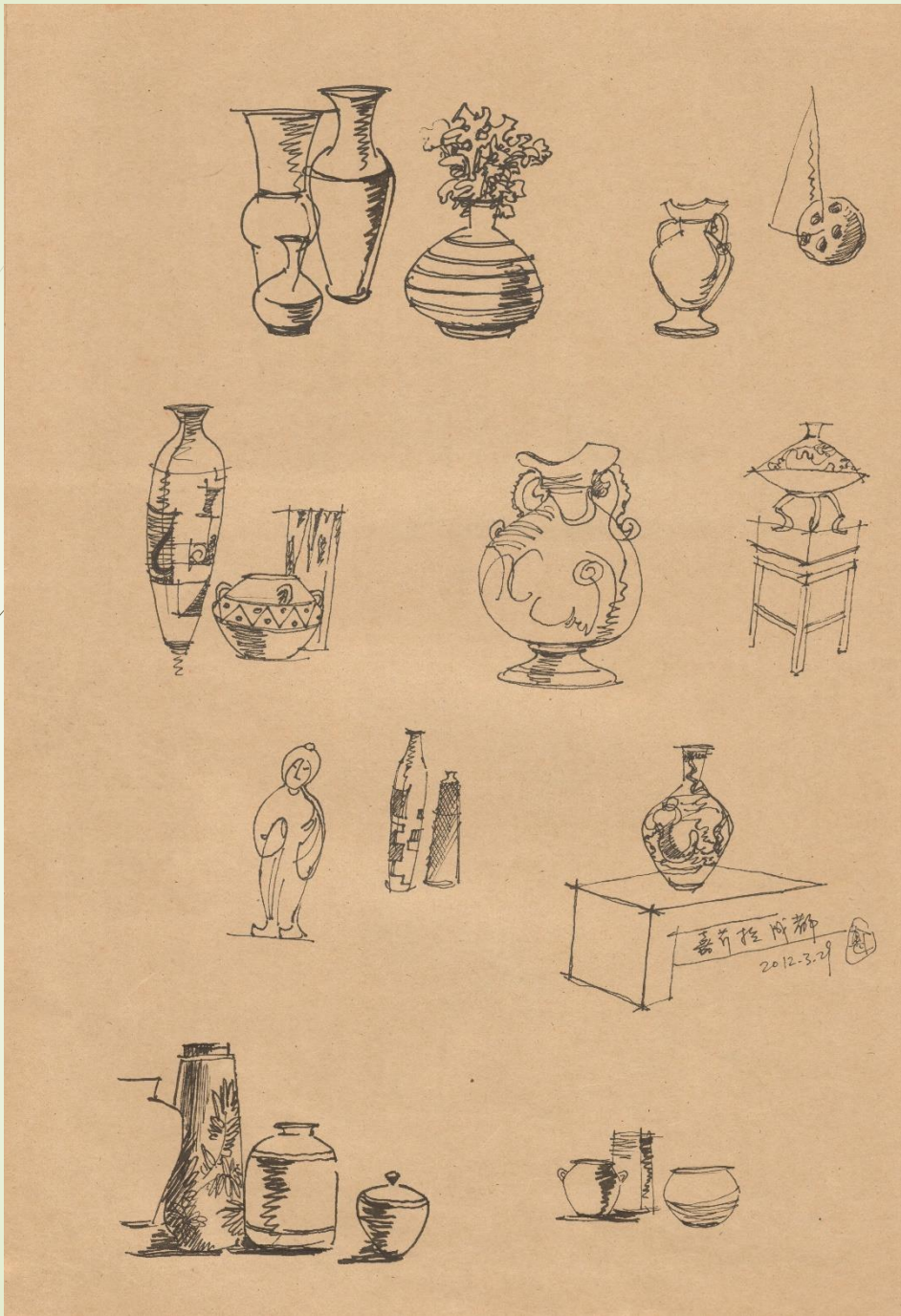

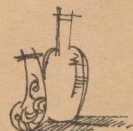
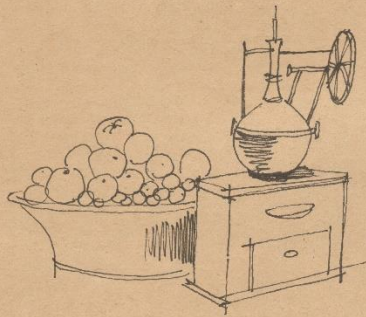
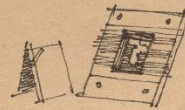
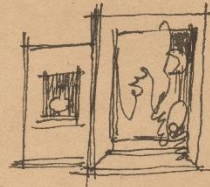
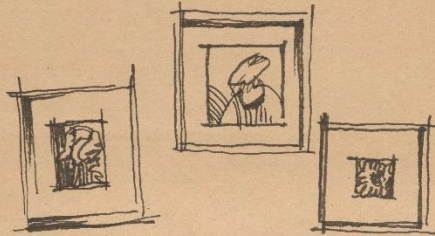
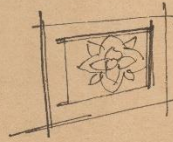

景芹 2012.4.9



陈设品分为纯艺术陈设品和实用两种。

- ①与居室功能一致
- ②与家具尺寸比例一致
- ③与设计风格一致
- ④与家具布置方向一致



嘉芹能成静
2013.3.26



嘉芹能成静

2013.3.26





嘉莉於成都



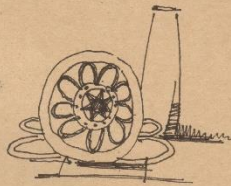
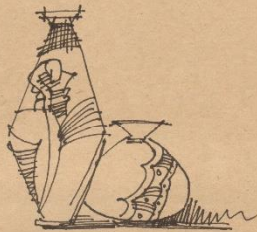
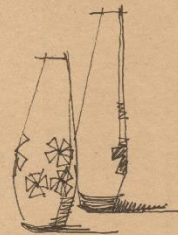
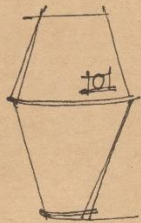

袁芹於 四川成都
2013. 4. 18

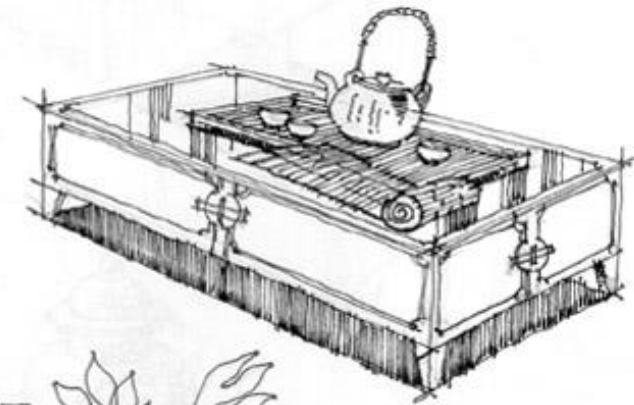

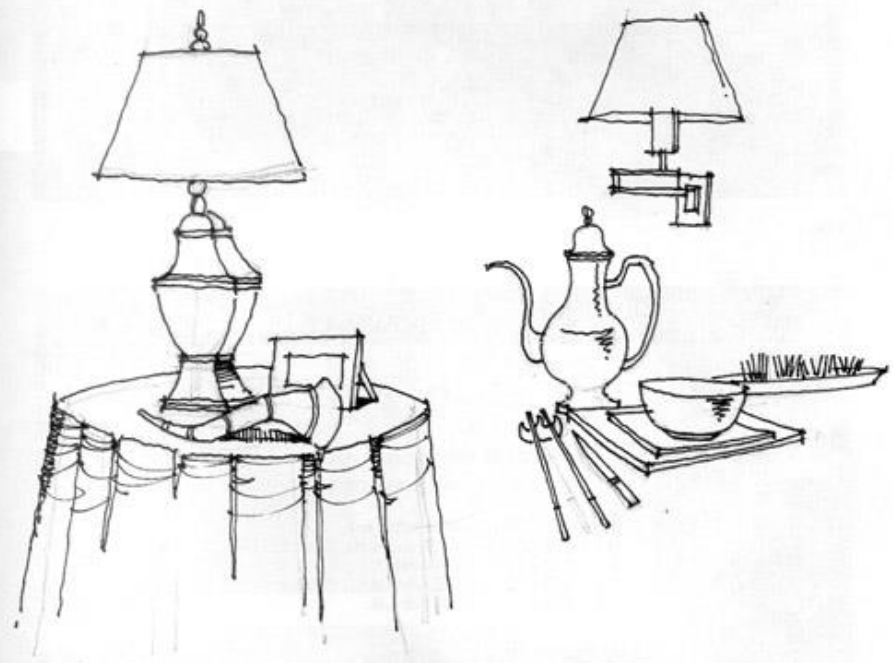
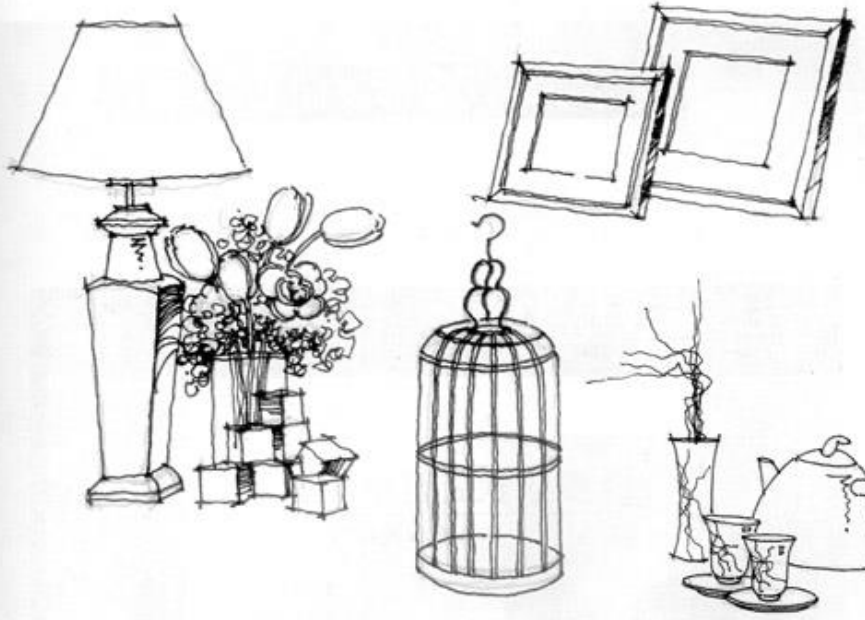





金銀器



尺米高青綠古銅盤



玻璃盤

古典工藝家具
Classical Furniture
891-12



2013.3.26

手绘家



室内设计网

