

# 硬笔手绘之技法

室内单体元素

---

(沙发、椅子)

主讲：傅嘉芹

# 第四章

## 室内陈设训练

### 第一节

单件或组练习 (沙发、茶几、床、灯饰、盆景、  
工艺品、卫浴、椅)

画沙发、茶几、床等陈设要从整体入手，简洁、概括、生动地表现它们。特别注意它们之间的透视比例关系、组合关系、虚实的处理。了解最新的款式、结构、材料。

虚实的处理

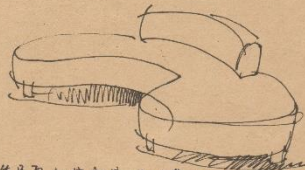
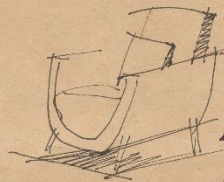
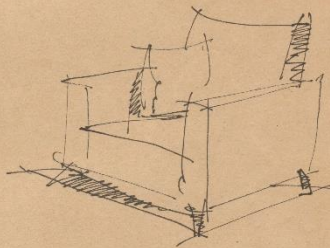
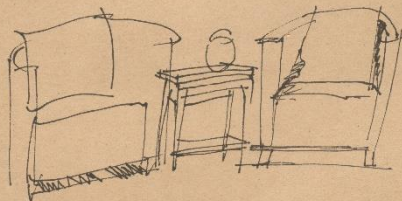
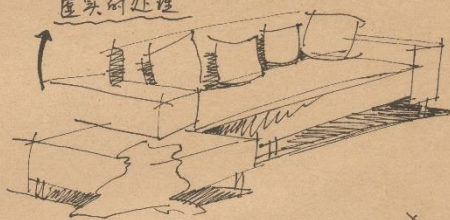
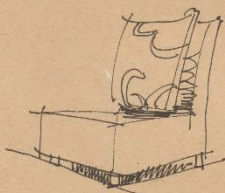

- ▲画好单件是画好室内空间的基础，任何复杂空间都是由个单件组成的。
- ▲先从左到右，从上到下，先画前面物体或线→后画被遮挡的物体或线。

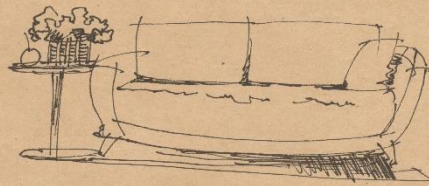
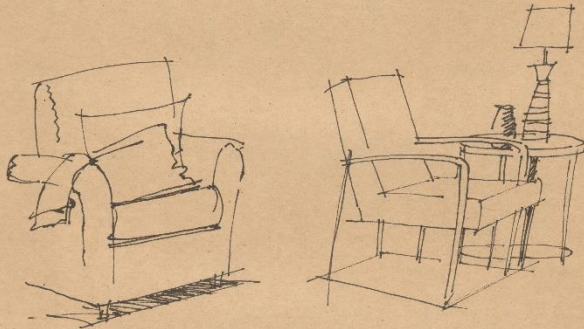
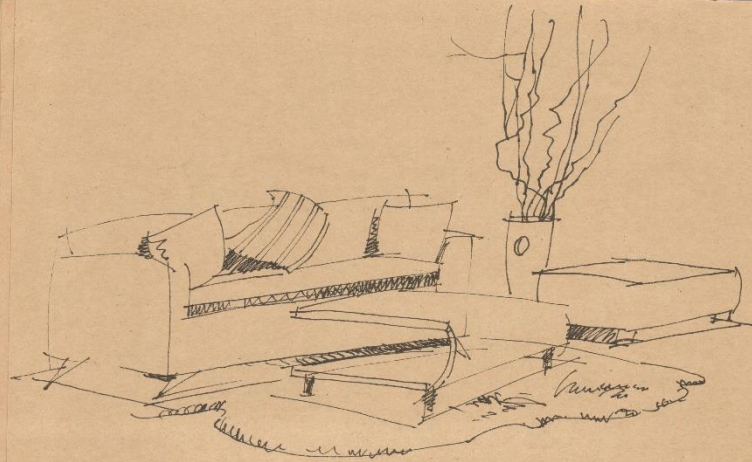

嘉齐松成都  
2012.3.8



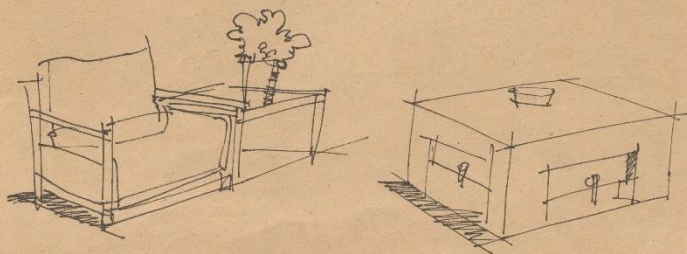
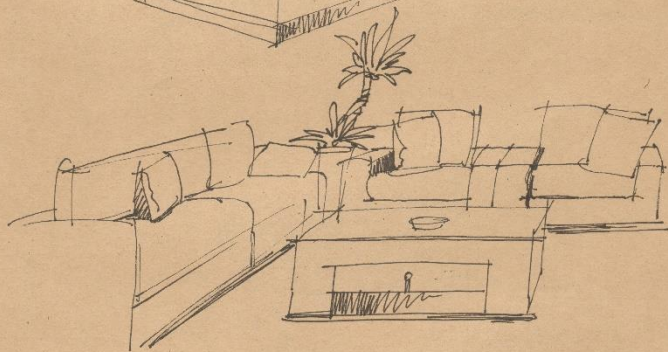
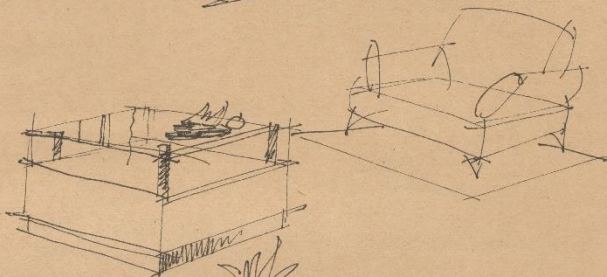
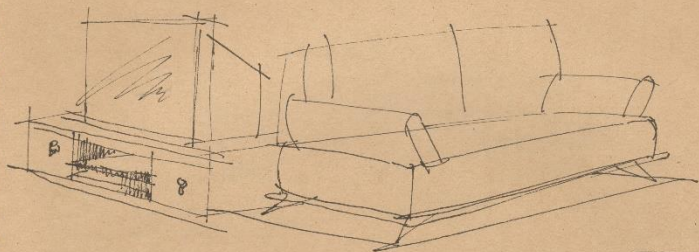

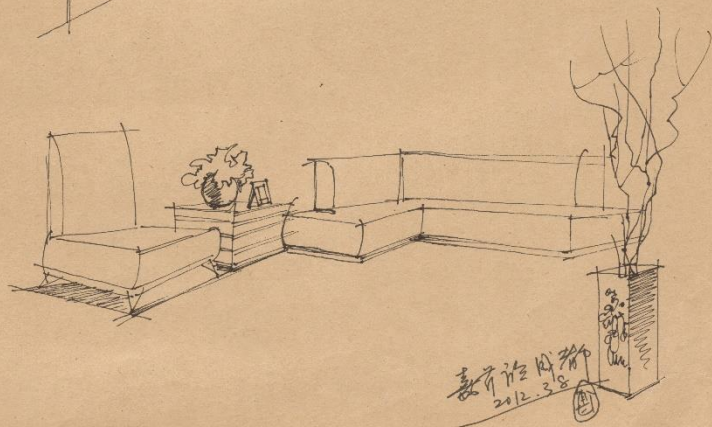
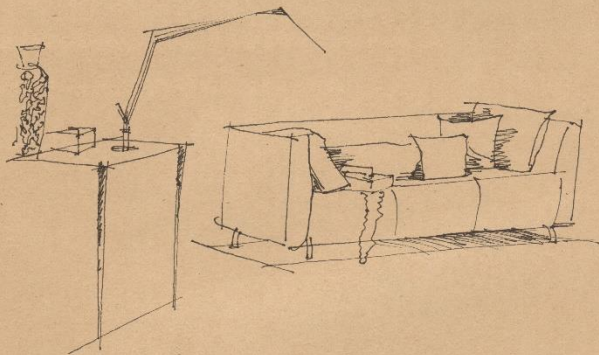
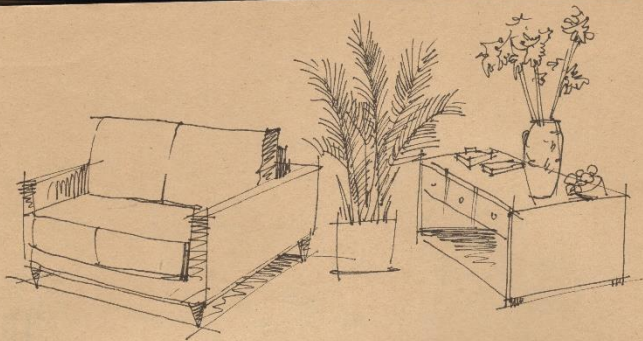

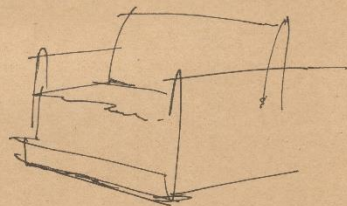
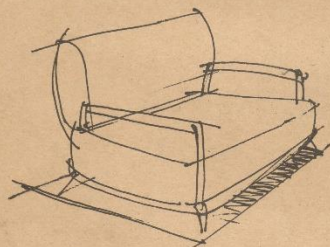
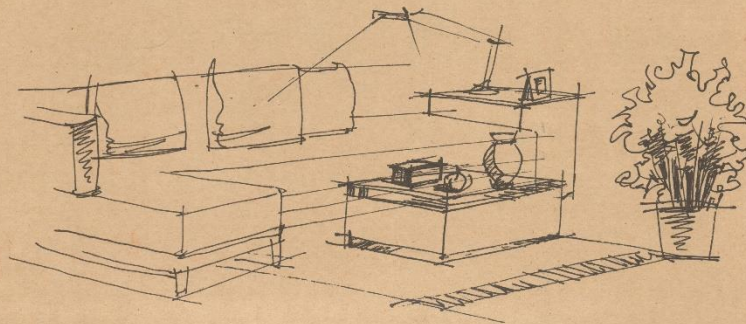

嘉芹於四川成都  
2012.3.9

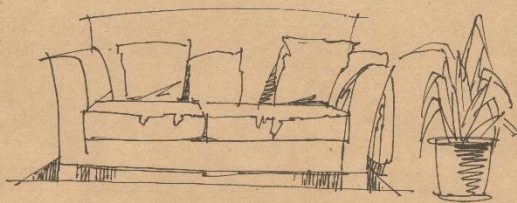

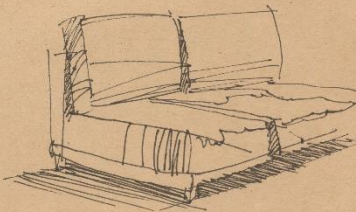
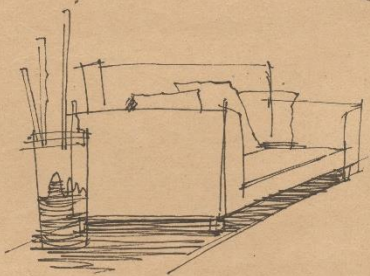
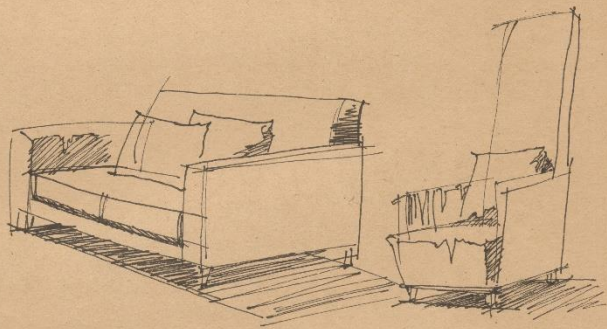
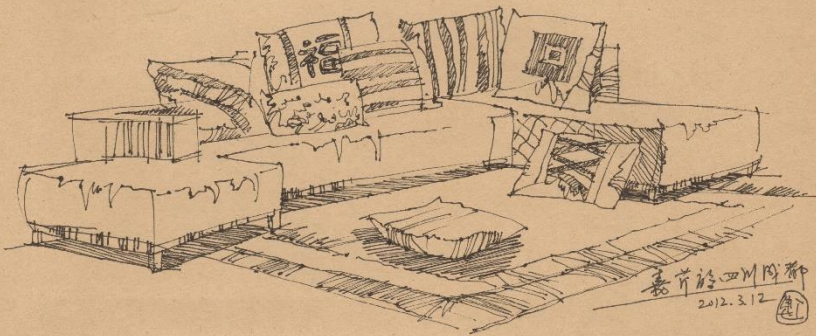

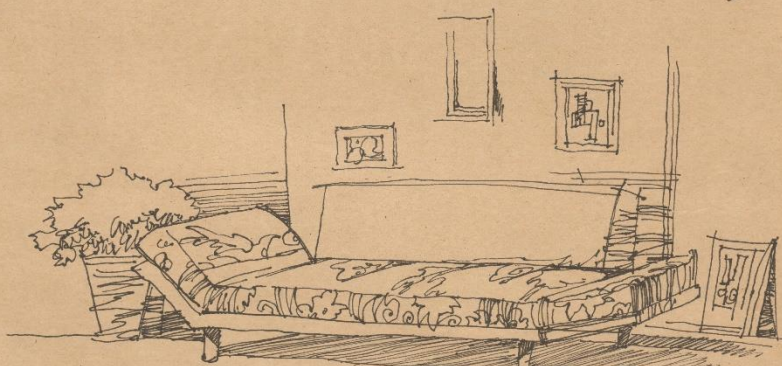
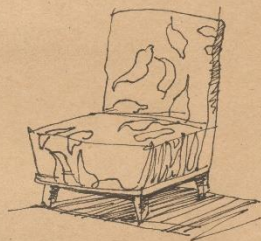
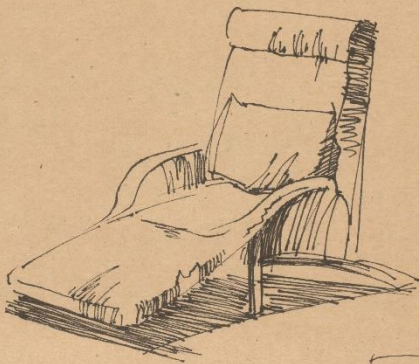
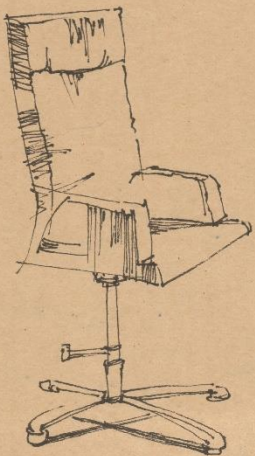

嘉莉的椅子  
2012.3.15



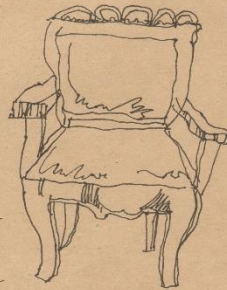
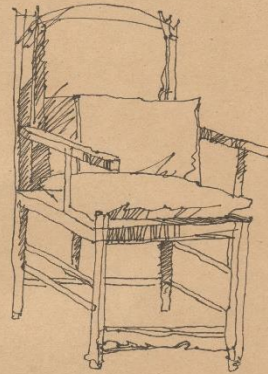
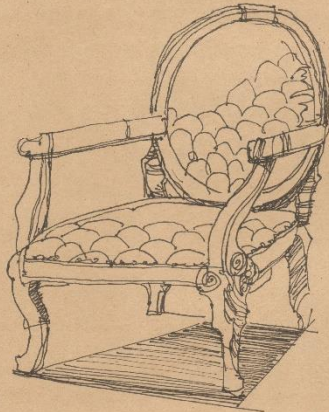
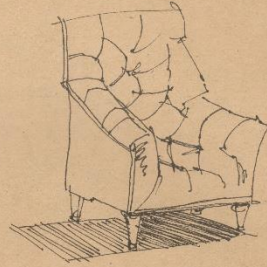

嘉竹设计  
2012.3.15

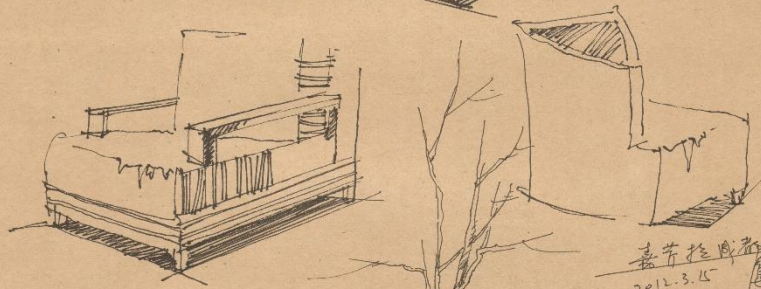
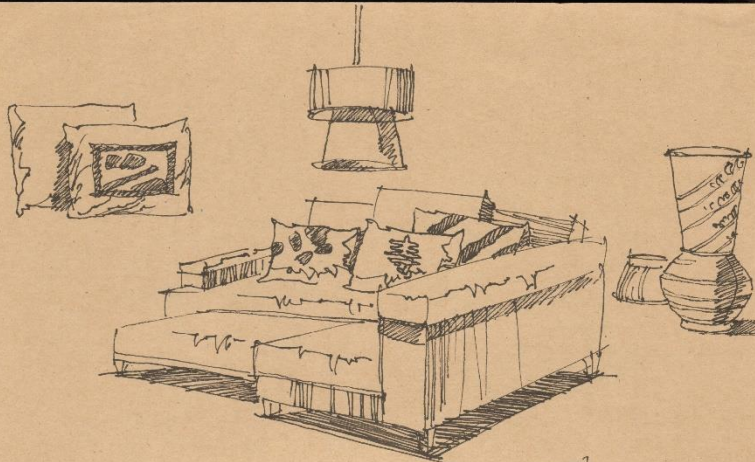

嘉芹控景  
2012.3.15

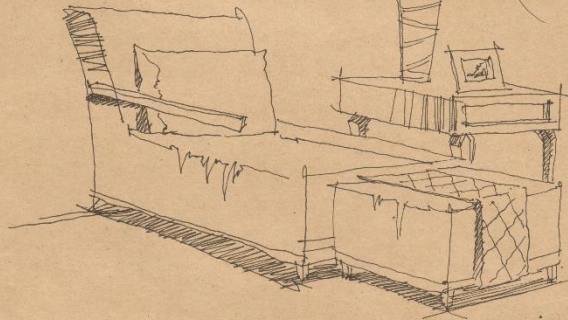

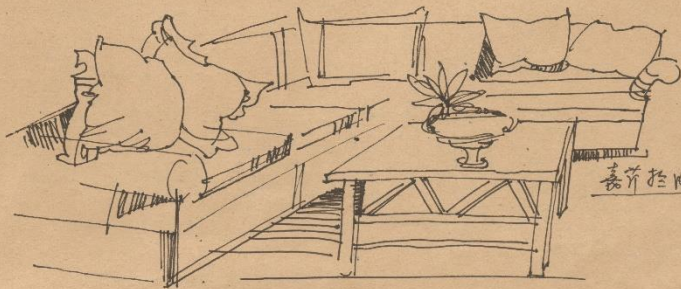
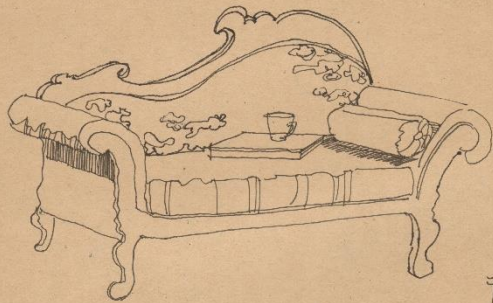
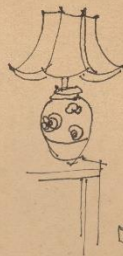
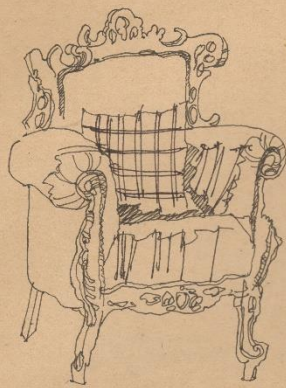

嘉芹於同都  
2012.3.16

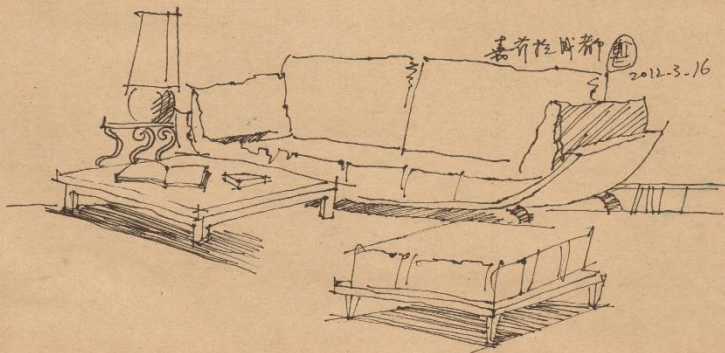
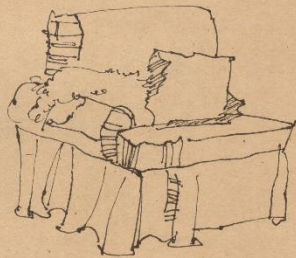
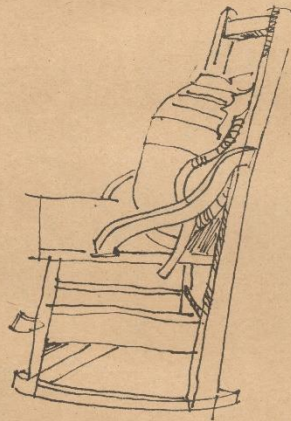
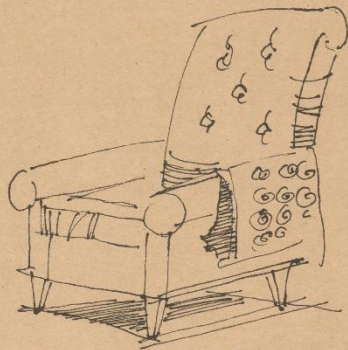
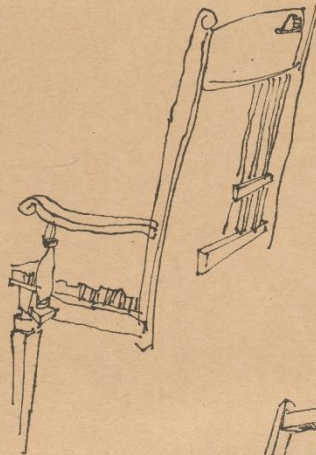

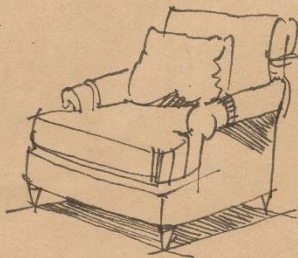
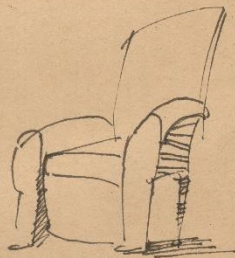
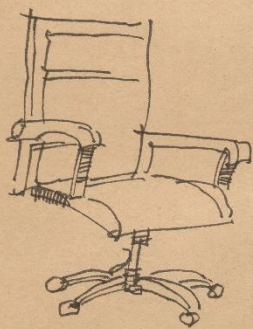
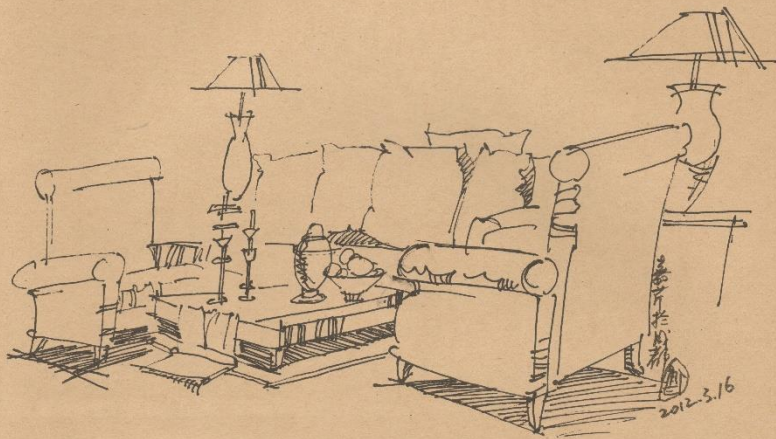

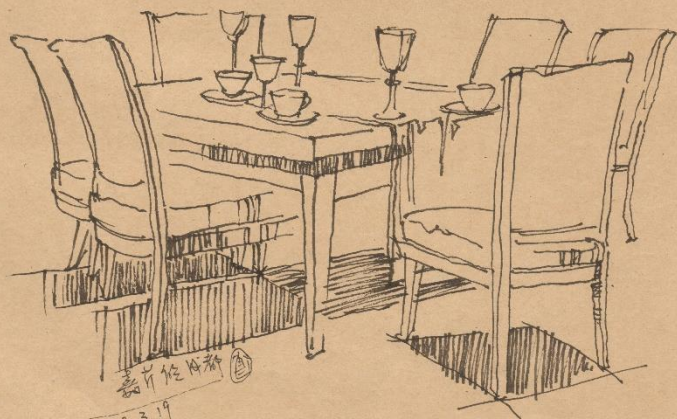

嘉竹设计

2012.3.19

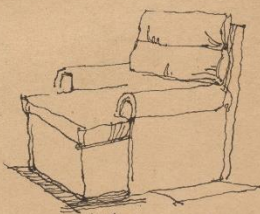
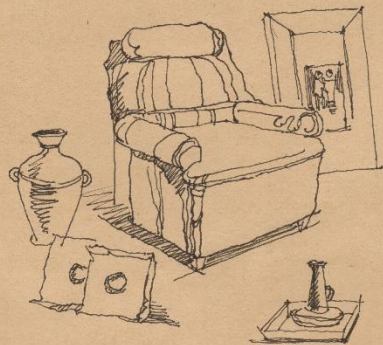
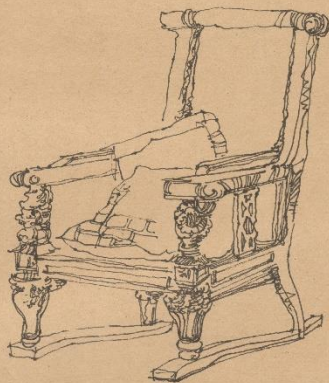
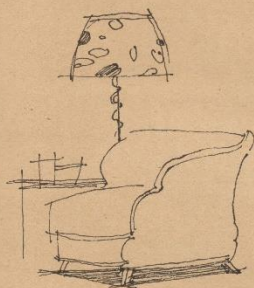
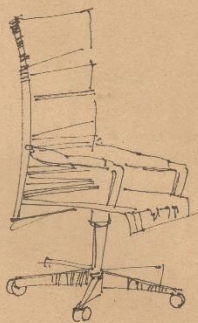

嘉竹於四川成都

2012. 3. 22



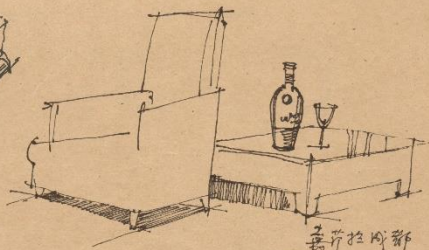
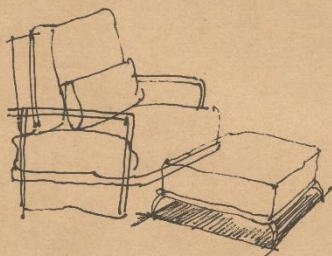
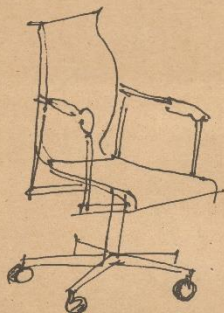

嘉莉拉成都

2012.3.22



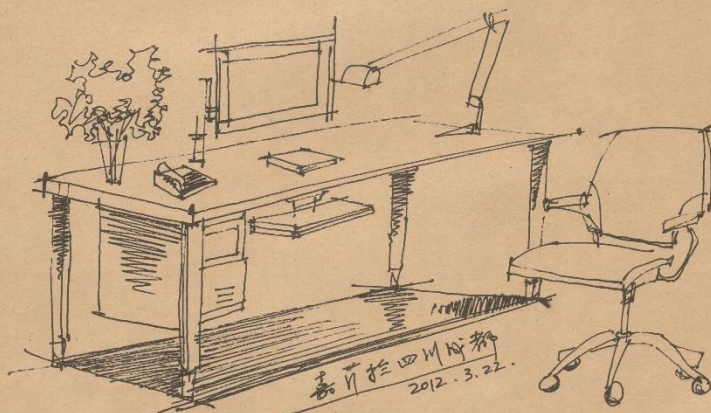
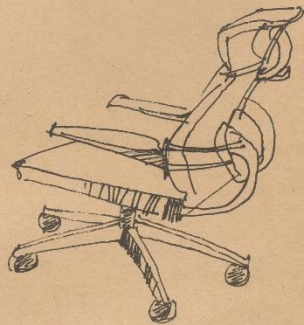
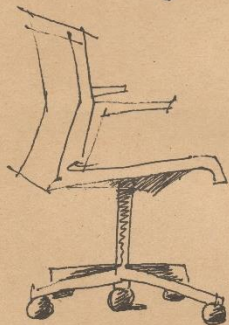
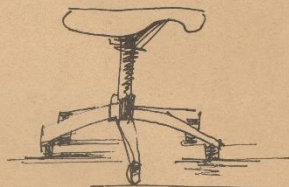
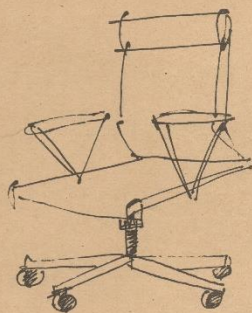

嘉莉在四川成都  
2012.3.22.



嘉莉拾成

2012.3.29

